

FALL SAVINGS 2022



Step Drill Sets High Speed Steel & TiN Coated

- 3-piece sets includes 12, 20 and 30mm diameter step drills
- Supplied in indexed metal case

HSS Series 470 | Code 754709

204.⁸⁴

TiN Series 475 | Code 754715

222.⁵⁹

Gold-P Drill Set High Speed Steel & TiN Coated

- 1/16" x 1/2" by 64ths
- 135° split point
- Straight shank
- Right hand spiral wide flutes
- Supplied in indexed metal case



Code 883345

146.²⁵

TAP MAGIC Cutting Fluids 16 oz. bottles

| EP-XTRA | ALUMINUM | XTRA-THICK | PROTAP | AQUEOUS | ECO-OIL |
|---|--|---|---|---|---|
| | | | | | |
| Code 219202 | Code 219210 | Code 219238 | Code 219218 | Code 219225 | Code 219232 |
| 15.⁸⁸ | 15.⁹¹ | 19.¹¹ | 15.⁹³ | 14.⁹² | 16.³⁴ |
| Ozone-friendly formula that provides outstanding performance on all cuts and all metals | Cutting fluid of choice for work on aluminum, brass, copper, and other soft metals | Heavyweight champion for hard metals – inconel, titanium, stainless... any metal up to 45 HRC | Eco-friendly, biodegradable and can be applied to any and all cutting operations and metals | Eco-friendly, non-corrosive, water-based formula that is easy to clean up and biodegradable | Meets the requirements of NSF's HI Food Grade certification. Biodegradable with natural oil base that's low in odor and smoke |

YOUR AUTHORIZED KAR DISTRIBUTOR:



E.M. PRECISE TOOL LTD.

CUTTING TOOLS • PRECISION TOOLS • COOLANTS

216A Arvin Avenue, Stoney Creek, ON L8E 2L8
 P: (905) 664-2644 | TF: 1 (800) 267-7569
 E: info@emprecise.com | www.emprecise.com



FALL SAVINGS

CNC Spotting Drills

HSS-E Cobalt - Uncoated & RED-X Coated



- 90° angle
- 118° point geometry for improved penetration rates while reinforcing the point
- Double ended for cost savings
- Available in 4-Piece sets or sold individually
- RED-X coating provides increased speeds and feeds and allows machining up to 55 HRC

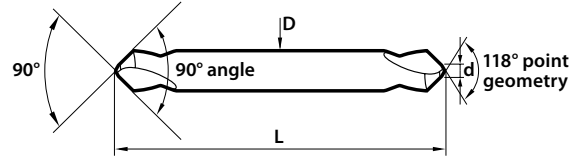
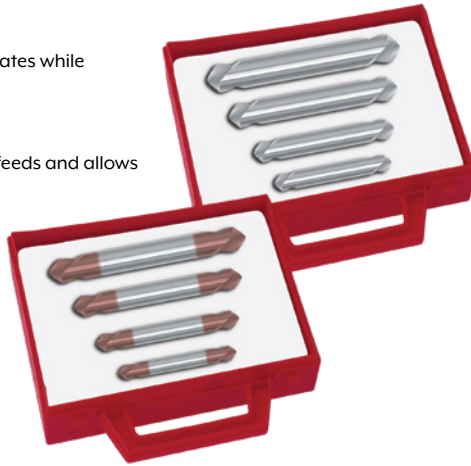

Individual Spotting Drills

4-Piece Sets *(includes 1 of each individual size)*

HSS-E Cobalt Code 540090 **70.38**
 RED-X Coated Code 540095 **100.36**

| D (Inch) | d (Inch) | L (Inch) | 90° Series 019 HSS-E COBALT | | 90° Series 0919 RED-X COATED | |
|----------|----------|----------|-----------------------------|-------|------------------------------|-------|
| | | | Code | Price | Code | Price |
| 3/16 | 1/16 | 2 | 540091 | 11.37 | 540096 | 14.98 |
| 1/4 | 3/32 | 2 | 540092 | 12.07 | 540097 | 17.07 |
| 3/8 | 9/64 | 3 | 540093 | 18.88 | 540098 | 30.65 |
| 1/2 | 3/16 | 4 | 540094 | 29.23 | 540099 | 39.91 |

Countersink Sets

High Speed Steel TiN Coated | Inch | 60°, 82° & 90°



With Hole 5-Piece Sets

60° TiN | Code 601291
 82° TiN | Code 601292
 90° TiN | Code 601293



278.23/ea.



Single Flute 6-Piece Sets

60° TiN | Code 601227
 82° TiN | Code 601228
 90° TiN | Code 601229

195.90/ea.

Combined Drill & Countersinks

High Speed Steel TiN Coated | 82° & 90° | Plain Type



| Size | Ø Body (Inch) | Ø Point (Inch) | Point Length (Inch) | Overall Length (Inch) | 82° Series 154 HSS M2 | | 90° Series 155 HSS M2 | |
|------|---------------|----------------|---------------------|-----------------------|-----------------------|-------|-----------------------|-------|
| | | | | | Code | Price | Code | Price |
| 1 | 1/8 | 3/64 | 1/16 | 1-1/4 | 540511 | 13.55 | 540521 | 13.55 |
| 2 | 3/16 | 5/64 | 7/64 | 1-7/8 | 540512 | 14.32 | 540522 | 14.32 |
| 3 | 1/4 | 7/64 | 9/64 | 2 | 540513 | 14.91 | 540523 | 14.91 |
| 4 | 5/16 | 1/8 | 5/32 | 2-1/8 | 540514 | 15.59 | 540524 | 15.59 |
| 5 | 7/16 | 3/16 | 1/4 | 2-3/4 | 540515 | 23.95 | 540525 | 23.95 |
| 6 | 1/2 | 7/32 | 19/64 | 3 | 540516 | 35.77 | 540526 | 35.77 |
| 7 | 5/8 | 1/4 | 5/16 | 3-1/4 | 540517 | 51.87 | 540527 | 51.94 |
| 8 | 3/4 | 5/16 | 13/32 | 3-1/2 | 540518 | 81.11 | 540528 | 81.81 |



SAVINGS START NOW



End Mills



Micrograin Solid Carbide | Uncoated & TiAlN-Futura Coated | 4 Flute | Center Cut

- Suitable for cutting hardened and high alloy steels, steel casting, chill casting, malleable cast iron, CrNi-steels, brass, copper, aluminum with a high percentage of silicon and abrasive plastics



Tolerance: 0/-0.0012



| Ø Cutter (Inch) | Ø Shank (Inch) | LONG LENGTH | | | | | | EXTRA LONG LENGTH | | | | | |
|-----------------|----------------|-------------|------------|----------|--------|--------------|--------|-------------------|------------|----------|--------|--------------|--------|
| | | LOC (Inch) | OAL (Inch) | UNCOATED | | TIALN-FUTURA | | LOC (Inch) | OAL (Inch) | UNCOATED | | TIALN-FUTURA | |
| | | | | Code | Price | Code | Price | | | Code | Price | Code | Price |
| 1/8 | 1/8 | 3/4 | 2-1/4 | 932892 | 11.66 | 934580 | 15.86 | 1 | 3 | 932744 | 14.03 | 934620 | 18.72 |
| 3/16 | 3/16 | 3/4 | 2-1/4 | 932895 | 13.26 | 934900 | 17.35 | 1-1/8 | 3 | 932747 | 15.91 | 934911 | 20.60 |
| 1/4 | 1/4 | 1-1/8 | 3 | 932898 | 16.29 | 934582 | 21.00 | 1-1/2 | 4 | 932750 | 19.63 | 934622 | 26.07 |
| 5/16 | 5/16 | 1-1/8 | 3 | 932901 | 28.40 | 934583 | 36.87 | 1-5/8 | 4 | 932753 | 34.05 | 934623 | 44.31 |
| 3/8 | 3/8 | 1-1/8 | 3 | 932904 | 35.09 | 934901 | 52.16 | 1-3/4 | 4 | 932756 | 42.16 | 934912 | 52.16 |
| 7/16 | 7/16 | 2 | 4 | 932907 | 65.79 | 934585 | 77.67 | 3 | 6 | - | - | 934625 | 111.03 |
| 1/2 | 1/2 | 2 | 4 | 932910 | 68.04 | 934586 | 78.07 | 3 | 6 | 932762 | 91.98 | 934626 | 127.81 |
| 5/8 | 5/8 | 2-1/4 | 5 | 932913 | 136.77 | 934902 | 151.35 | 3 | 6 | 932765 | 164.19 | 934913 | 183.37 |
| 3/4 | 3/4 | 2-1/4 | 5 | 932916 | 177.28 | 934588 | 197.91 | 3 | 6 | 932768 | 212.67 | 934628 | 240.04 |
| 1 | 1 | 2-1/4 | 5 | 932919 | 355.27 | 934589 | 381.98 | 3 | 6 | 932771 | 426.25 | 934629 | 458.59 |



Deburring Sets



Standard, Heavy Duty & Glo-Burr

Mango IIB + 2
Extra Close
Standard B

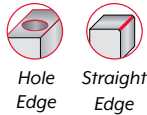

Code 550602 **11.22**

INCLUDES: 2 HSS standard B blades - B10, B20 | Mango IIB ergonomic handle with safety lock

Mango IIE + 3
Extra Close
Heavy Duty E

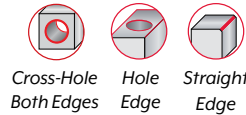

Code 550603 **13.93**

INCLUDES: 3 HSS heavy duty E blades - E100, E200, E300 | Mango IIE ergonomic handle with safety lock

Glo-Burr Sets
Standard B / Heavy Duty E

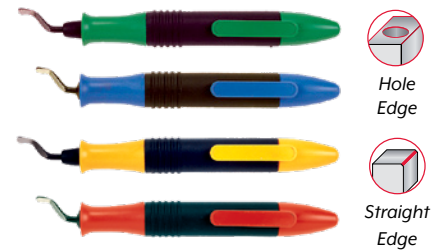

- Easy-to-grip, strong, yet lightweight
- Pocket clip and blade storage in handle
- Deburrs steel, aluminum, copper, and plastics
- Glo-Burr B with B10 (holds other B blades)
- Glo-Burr E with heavy duty E100 blade (holds other E blades)

Glo-Burr B Sets
6.38 /ea.

Glo-Burr E Sets
6.82 /ea.

B SET CODES: Green 550962 | Blue 550963 | Yellow 550961 | Red 550960

E SET CODES: Green 550967 | Blue 550968 | Yellow 550966 | Red 550965

SHAVIV B12 Modified Blade

Special Blade for Plastics

SIMILAR TO B25 BLADE!
MORE AGGRESSIVE CUT!

HSS | Short-nosed
Fits B handles/holders



WHILE QUANTITIES LAST

19.99 /box of 100

Code 550830 (individual)

SHAVIV Blade Set

Multi-Purpose
Standard B Blades

Code 551001

40.76



INCLUDES: 5 pair of B blades: B10P (2), B11P (2), B12P (2), B20P (2), and B30P (2)

SHAVIV Exclusively Available at **KAR** in Canada

FALL SAVINGS

Calipers



Electronic Standard Model



OPTIONAL ACCESSORY: SPC cable

- Resolution: 0.0005"/0.01mm
- Buttons: on/off, zero, inch/mm
- Auto power off, move digital unit to turn power on
- Battery CR2032
- Data output
- Stainless steel construction
- Supplied in fitted storage case



Dial Calipers

- Graduations: 0.001"
- One revolution equals: 0.1"
- Shock proof dial indicator
- Supplied in fitted storage case

0-6 Inch/0-150mm
Accuracy: ± 0.0010 "
Code 817000

59.19

0-8 Inch/0-200mm
Accuracy: ± 0.0015 "
Code 817001

81.70

0-12 Inch/0-300mm
Accuracy: ± 0.0015 "
Code 817002

143.37

0-6 Inch/0-150mm
Accuracy: ± 0.0015 "
Code 816028

71.19

0-8 Inch/0-200mm
Accuracy: ± 0.0020 "
Code 816030

94.28

0-12 Inch/0-300mm
Accuracy: ± 0.0020 "
Code 816032

172.52

INSIZE Exclusively Available at **KAR** in Canada



THE **MACHINIST'S TOOLBOX**

MACHINIST'S RED SEAL DEALS

SAVE NOW AT KAR

on these featured essentials for the Red Seal Machinist's toolbox!

Magnetic Stands

with Flex Arm | For Dial Test Indicators



Dial Test Indicators

- Jeweled bearing
- Carbide contact point
- Two measuring directions
- Anti-magnetic body
- Supplied with two clamps: 5/32" and 3/8" diameters
- Supplied in fitted storage case



FLEX ARM STAND
Code 282892
62.51

- Applicable holding stem \varnothing : 3/8", 8mm, 4mm
- Magnetic force: 176lbf/80kgf

| Range (Inch) | Graduation (Inch) | Accuracy (Inch) | Dial Reading | $\varnothing A$ (Inch) | L (Inch) | DIAL TEST INDICATORS | |
|--------------|-------------------|-----------------|--------------|------------------------|----------|----------------------|---------------|
| | | | | | | Code | Price |
| 0.03 | 0.001 | ± 0.001 | 0-15-0 | 1.181 | 0.500 | 282858 | 81.09 |
| | 0.0005 | ± 0.0005 | | | | 816170 | 106.05 |
| 0.008 | 0.0001 | ± 0.0001 | 0-40-0 | 1.457 | 0.563 | 816172 | 141.31 |
| | 0.001 | ± 0.001 | | | | 282859 | 83.75 |
| 0.03 | 0.001 | ± 0.001 | 0-15-0 | 1.457 | 0.500 | 282860 | 85.70 |
| | 0.0005 | ± 0.0005 | | | | 282861 | 141.86 |
| 0.008 | 0.0001 | ± 0.0001 | 0-40-0 | 1.457 | 0.563 | 282861 | 141.86 |
| | 0.001 | ± 0.001 | | | | | |



Offer ends
December 30, 2022



INSIZE TOOLS THAT MEASURE UP

Welding Gage

With Adjustable Scale

- Adjustable scale to compensate for pointer wear
- Stainless steel
- Supplied in storage pouch

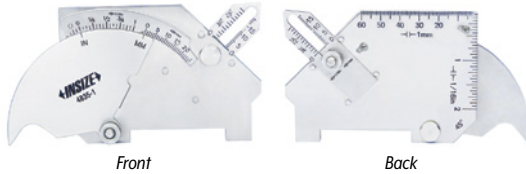

Code 877031

69.19

Edge Finder

With Hardened Shank & Contact Point



Shank: Ø3/8"
Contact Point: Ø0.2"
Accuracy: ±0.0003"
Code 816383

51.46

Small Hole Gage Set

- For small holes, slots, grooves, etc.
- Satin chrome finish
- Supplied in storage pouch



4 Gages
0.125 to 0.5 Inch
Code 816204

30.81

| Measurement | Range Inch (mm) | Accuracy | Graduation Inch (mm) |
|-------------------------|--------------------|----------|-------------------------|
| Crown height | 0-1 (0-25) | ±0.02" | 1/16 (1) |
| Fillet weld leg height | 0-1 (0-25) | ±0.02" | 1/16 (1) |
| Misalignment (high-low) | 0-1 (0-25) | ±0.02" | 1/16 (1) |
| Undercut depth | 0-1/8 (0-2) | ±0.02" | 1/16" (1) |
| Fillet weld throat size | 0-3/4 (0-20) | ±0.02" | 1/16 (1) |
| Angle of preparation | 0-60° | ±1° | 5° |
| Length | 0-2 (0-60) | ±0.02" | 1/16" (1) |
| 45° angle | - | ±1° | - |

Thread Plug Gages



- Supplied with GO and NO-GO end
- Class 6H
- ISO1502 standard



- Supplied with GO and NO-GO end
- Class 2B
- ANSI B1.2 standard

| Size (mm) | METRIC | |
|-------------|--------|-------|
| | Code | Price |
| M2 x 0.4 | 284053 | 58.09 |
| M2.2 x 0.45 | 284054 | 62.36 |
| M2.5 x 0.45 | 284055 | 57.11 |
| M3 x 0.5 | 284056 | 57.11 |
| M3.5 x 0.6 | 284057 | 61.37 |
| M4 x 0.7 | 284058 | 41.65 |
| M5 x 0.8 | 284059 | 41.65 |
| M6 x 1 | 284060 | 41.65 |
| M7 x 1 | 816680 | 37.60 |
| M8 x 1.25 | 284061 | 41.65 |
| M9 x 1.25 | 816681 | 37.60 |
| M10 x 1.5 | 284062 | 49.81 |
| M11 x 1.5 | 816682 | 45.22 |
| M12 x 1.75 | 284063 | 56.97 |
| M14 x 2 | 284064 | 59.66 |

| Size (mm) | METRIC | |
|-----------|--------|--------|
| | Code | Price |
| M16 x 2 | 284065 | 60.04 |
| M18 x 2.5 | 284066 | 65.17 |
| M20 x 2.5 | 284067 | 65.29 |
| M22 x 2.5 | 284068 | 66.78 |
| M24 x 3 | 284069 | 77.21 |
| M27 x 3 | 284070 | 77.21 |
| M30 x 3.5 | 284071 | 89.32 |
| M33 x 3.5 | 284072 | 92.65 |
| M39 x 4 | 284074 | 124.34 |
| M42 x 4.5 | 284075 | 165.75 |
| M45 x 4.5 | 284076 | 169.23 |
| M48 x 5 | 284077 | 179.68 |
| M52 x 5 | 284078 | 189.15 |
| M56 x 5.5 | 284079 | 203.12 |
| M60 x 5.5 | 284080 | 216.32 |

| Size | AMERICAN STANDARD | |
|-------------|-------------------|-------|
| | Code | Price |
| 4-40 UNC | 816651 | 64.52 |
| 6-32 UNC | 816652 | 58.99 |
| 8-32 UNC | 816653 | 58.99 |
| 10-32 UNF | 816654 | 64.52 |
| 1/4-20 UNC | 816655 | 58.12 |
| 1/4-28 UNF | 816656 | 61.28 |
| 5/16-18 UNC | 816657 | 58.12 |
| 5/16-24 UNF | 816658 | 58.12 |
| 3/8-24 UNF | 816660 | 64.52 |
| 7/16-20 UNF | 816661 | 64.31 |
| 1/2-13 UNC | 816662 | 70.11 |
| 1/2-20 UNF | 816663 | 67.79 |
| 9/16-18 UNF | 816664 | 67.79 |
| 5/8-11 UNC | 816665 | 92.92 |
| 5/8-18 UNF | 816666 | 70.77 |
| 3/4-10 UNC | 816667 | 94.17 |
| 3/4-16 UNF | 816668 | 78.36 |

Thread Plug Gages are supplied with a manufacturer inspection certificate

For more INSIZE TOOLS THAT MEASURE UP, see KAR's "INSIZE | 2022 TOP 50+ BEST SELLERS" 8-Page brochure online at KAR.ca/promotions or pick up your copy at your local KAR Distributor

FALL SAVINGS

Quick Change Tooling For Morse Taper Spindles



- For use on radial drills, boring mills, or any machine with Morse taper spindles
- Interchangeable with Jahrl

Holder - Model 060201



- Max rotation speed 2000 RPM
- Max concentricity achieved by taper coupling
- 10 mm clearance between workpiece and tool is sufficient
- Rotation in either direction
- Equally effective in vertical or horizontal position

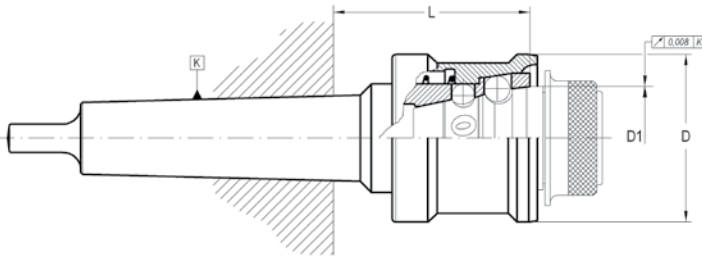

QC Holder M3
Code 369400

473.⁶⁶

QC Holder M4
Code 369401

473.⁶⁶

QC Holder M4
Code 369402

645.⁶⁴

QC Holder M5
Code 369403

1122.⁶²

| K | D1 (mm) | L (mm) | D (mm) | QC HOLDER | |
|----|------------|-----------|-----------|-----------|-------|
| | | | | Code | Price |
| M3 | 40 | 77 | 63 | 369400 | |
| M4 | 40 | 78 | 63 | 369401 | |
| M4 | 51.5 | 95 | 83 | 369402 | |
| M5 | 68.7 | 116 | 100 | 369403 | |

Adapters - Model 069901

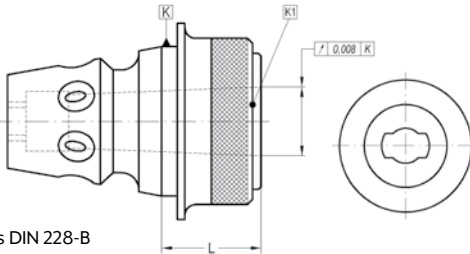

- For tapered Morse Taper tools DIN 228-B

| K (mm) | K1 (mm) | L (mm) | QC ADAPTERS | |
|-----------|------------|-----------|-------------|-------------------------|
| | | | Code | Price |
| 40 | M1 | 25 | 369411 | |
| | M2 | 29 | 369412 | 204. ⁵¹ /ea. |
| | M3 | 44 | 369413 | |
| 51.5 | M1 | 34 | 369421 | |
| | M2 | 34 | 369422 | 240. ⁰⁸ /ea. |
| | M3 | 34 | 369423 | |
| | M4 | 55 | 369424 | 272. ⁶¹ |
| 68.7 | M1 | 34 | 369431 | |
| | M2 | 34 | 369432 | 317. ⁹⁵ /ea. |
| | M3 | 34 | 369433 | |
| | M4 | 43 | 369434 | |
| | M5 | 70 | 369435 | 379. ⁶⁷ /ea. |

CNC Bar Pullers Compact & Heavy Duty



Compact Bar Pullers

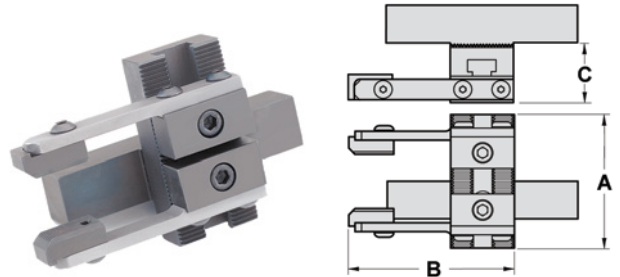

- Great for use with small CNC lathes - compact design minimizes tool interference
- Very easy to setup and use
- Unit can pull round, square, and hex stock
- Flexible heat-treated steel fingers provide strong gripping force
- Each compact bar puller includes one set of serrated jaws and one blank spindle bushing

Order insert holder and insert separately.

Additional sizes and shank styles are available.

Contact your KAR distributor for more information.

| Shank (Inch) | Gripping Range (Inch) | A (Inch) | B (Inch) | C (Inch) | COMPACT | |
|-----------------|-----------------------------|-------------|-------------|-------------|---------|---------------------|
| | | | | | Code | Price |
| 3/4 sq. | 1/8 - 2-1/4 | 2-5/8 | | | 217051 | 1155. ⁶⁶ |
| 1 sq. | 1/8 - 2-1/4 | 2-5/8 | 3-1/4 | 1-3/16 | 217052 | 1155. ⁶⁶ |
| 1 sq. | 1/8 - 3 | 2-5/8 | | | 217053 | 1230. ⁸⁸ |

Heavy Duty Bar Pullers

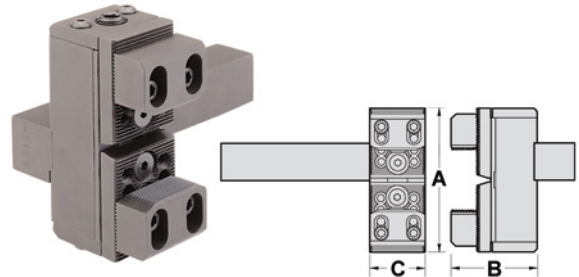

- Gripping range from 1/8" to 6-1/2"
(extra capacity jaws sold separately)
- Gripping force is easily adjusted by altering spring pressure
- Jaws have two gripping surfaces: one side is serrated for increased gripping power, the other side is smooth to help prevent marking
- Smooth side is also used when pulling small diameter stock
- Very easy to set up and use
- Each unit comes with one set of standard jaws and one blank spindle bushing

| Shank (Inch) | Gripping Range (Inch) | | A (Inch) | B (Inch) | C (Inch) | HEAVY DUTY | |
|-----------------|-----------------------|---------------------------|-------------|-------------|-------------|------------|---------------------|
| | Standard Jaws | Extra Capacity Jaws | | | | Code | Price |
| 3/4 sq. | | | 3-7/8 | 2-9/16 | 1-1/2 | 217058 | 1902. ⁷⁵ |
| 1 sq. | 1/8 - 2-1/4 | 1-7/8 - 3-3/4 | 3-7/8 | 2-9/16 | 1-1/2 | 217059 | 2020. ⁷⁸ |
| 1 sq. | 1/8 - 4-7/8 | 1-7/8 - 6-1/2 | 6-3/4 | 2-3/4 | 1-3/4 | 217062 | 2552. ⁵⁷ |

SAVINGS START NOW



Simple Indexing Spacers

Machine Mount | Horizontal/Vertical



Masking Plates

Model CC-6
Code 277080
1256.⁰⁰

Model CC-8
Code 277082
1747.⁹⁸

- Mount on milling machines, drilling machines and other machine tools where an indexing facility is required
- Designed for use in horizontal or vertical positions
- Large center through hole suitable for large and long workpieces
- May be used with 3-jaw chuck
- Rapid indexing and easy operation, sharp for mass production
- Simple index includes 3-jaw chuck, masking plates 2, 3, 4, 6, 8 and 12
- Using the key guide block the center can be corrected quickly and accurately

| Model | Dividable Number | Ø Inner Jaw | Ø Outer Jaw | Ø Turret Hole | Ø Chuck Hole | Weight |
|-------|-----------------------|-------------|-------------|---------------|--------------|---------|
| CC-6 | 2, 3, 4, 6, 8, 12, 24 | 55 - 145 mm | 3 - 160 mm | 44 mm | 44 mm | 29.5 kg |
| CC-8 | 2, 3, 4, 6, 8, 12, 24 | 65 - 200 mm | 4 - 200 mm | 63 mm | 58 mm | 51.5 kg |

For more dimensions and details visit www.kar.ca

3-Jaw Self-Centering Lathe Chucks

Universal | Plain Back Mounting | 2-Piece Hard Reversible Jaws

- Semi-steel body, medium duty
- 3 pinion design

Each chuck is provided with:

- 1 set of hard master jaws
- 1 set of hard top reversible jaws
- 1 chuck wrench
- 1 set of mounting bolts
- 2 hex keys
- Eye bolts with 10-32" chucks
- Adapters required for plain back mounting

| Chuck Diameter (Inch) | RPM Max | M Thread | Bolt Length (Inch) | No. of Bolts Required |
|-----------------------|---------|------------|--------------------|-----------------------|
| 6 | 3000 | M10 x 1.5 | 0.98 | 6 |
| 8 | 2500 | M10 x 1.5 | 0.98 | 6 |
| 10 | 2000 | M12 x 1.75 | 1.18 | 6 |
| 12 | 1500 | M16 x 2 | 1.18 | 6 |
| 16 | 1000 | M16 x 2 | 1.57 | 6 |



gator chucks™
BY FUERDA

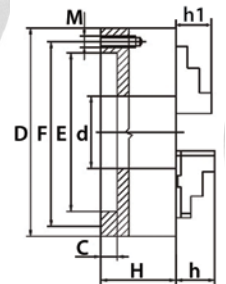

Ø 6 Inch
Code 410009

581.⁷⁰

Ø 8 Inch
Code 410010

781.²⁵

Ø 10 Inch
Code 410003

1044.⁴⁷

Ø 12 Inch
Code 410007

1549.⁷⁵

Ø 16 Inch
Code 410008

2326.⁷²

| D Chuck Diameter (Inch) | d Hole (Inch) | Maximum Hole Enlargements (Inch) | Model | C (Inch) | E (Inch) | F (Inch) | H (Inch) | h (Inch) | h1 (Inch) | Code |
|-------------------------|---------------|----------------------------------|----------|----------|----------|----------|----------|----------|-----------|--------|
| 6 | 1.65 | 1.93 | PS3-6"A | 0.16 | 4.92 | 5.51 | 2.54 | 1.69 | 1.26 | 410009 |
| 8 | 2.17 | 2.82 | PS3-8"A | 0.16 | 6.30 | 6.93 | 2.95 | 1.77 | 1.14 | 410010 |
| 10 | 2.99 | 3.58 | PS3-10"A | 0.20 | 7.87 | 8.82 | 3.35 | 2.09 | 1.34 | 410003 |
| 12 | 4.06 | 4.33 | PS3-12"A | 0.20 | 10.24 | 11.26 | 3.70 | 2.24 | 1.69 | 410007 |
| 16 | 5.35 | 5.75 | PS3-16"A | 0.20 | 12.99 | 14.25 | 4.13 | 2.69 | 2.16 | 410008 |

KAR OFFERS THE GATOR CHUCK COMPLETE LINE! Ask your local Distributor for more details!

KAR FALL SAVINGS



Chuck Stop Sets

Standard & Deluxe

3-Piece Standard Set
15, 20 and 25mm stops
Code 355985

382.63

5-Piece Deluxe Set
15, 20, 25, 30 and 35mm stops
Code 355986

665.38

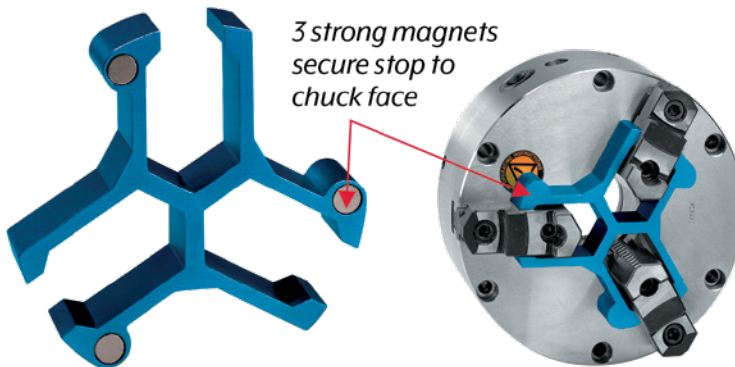

Dead Centers with Nut

Solid Centers | Alloy Steel

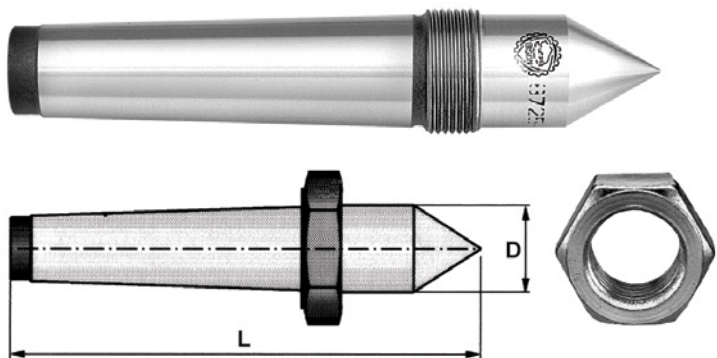

| Morse Taper | L (Inch) | D (Inch) | Spare Nut Reference | | DEAD CENTER WITH NUT | |
|-------------|----------|----------|---------------------|----------------|----------------------|--------------------|
| | | | Size (Inch) | Spare Nut Code | Code | Price |
| 1 | 3.54 | 0.48 | 0.94 | 826335 | 826323 | 86. ⁷¹ |
| 2 | 4.41 | 0.71 | 1.26 | 826336 | 826324 | 101. ⁸¹ |
| 3 | 5.43 | 0.95 | 1.61 | 826337 | 826325 | 124. ⁴⁴ |
| 4 | 6.89 | 1.24 | 2.17 | 826338 | 826326 | 179. ⁰⁸ |
| 5 | 8.54 | 1.76 | - | - | 826327 | 256. ³⁹ |
| 6 | 11.42 | 2.51 | 3.94 | 826340 | 826328 | 522. ²² |

Live Centers

High Speed Steel | Main Line Type N | Standard 60°



MAIN-LINE: Reliable top of the range live center for CNC and conventional lathes, and grinding machines

- Surface-hardened body
- Ground tapers conform to DIN228AT3
- Through-hardened spindle constructed from high-grade steel
- Spindle mounted by two needle bearings
- Thrust ball bearings to accommodate axial loads
- Over-pressure security through disc springs
- Reliable lip seal
- Continuous lubrication provided by a high quality grease



BODY AND SPINDLE MODELS

ST | Standard for normal loads

SU | Super for heavy duty loads and low turning rates

MORE DIMENSIONS: <https://tinyurl.com/2d5hjphn>
KAR OFFERS MORE ROTOR LIVE CENTERS & ACCESSORIES!
 Ask your local Distributor for more details!

MT1 STANDARD
Code 100101

723.93

MT2 STANDARD
Code 100102

625.61

MT2 SUPER
Code 100112

719.46

MT3 SUPER
Code 100113

804.37

MT4 STANDARD
Code 100104

813.29

MT5 SUPER
Code 100115

1501.50

MT6 STANDARD
Code 100106

1783.04



KAR Industrial Inc.
www.kar.ca

Toronto.....1-800-387-3127
 Montréal.....1-800-363-7862
 Edmonton.....1-866-440-4326

Offer valid until December 30th, 2022

*Products shown may not be exactly as illustrated Code 000319

FIND DISTRIBUTOR

MAKING IT EASY TO DO BUSINESS WITH SINCE 1954... CONTACT YOUR LOCAL KAR DISTRIBUTOR TODAY!